



valmont 
INDIA



HIGH MASTS

Your Area Lighting Solution.

Valmont is recognised throughout the world as an industry leader in engineered support structures and irrigation equipment. With more than 65 years of experience, Valmont has knowledge, expertise and resources to provide the highest quality products and services to the industry on time.

Valmont has been actively selling in the India Market since 2007 and from 2011 onwards supplies its quality products from its state of the art pole manufacturing and galvanising facility at Indapur, Pune District, Maharashtra.

You can depend on Valmont's high quality galvanised steel poles for an appealing solution to your roadways and street lighting needs. We offer round / octagonal / polygonal shape tapered poles, decorative brackets & accessories. Refer overleaf for the standard product range and specifications. Valmont also supplies Galvanised and powder coated poles and brackets for decorative appearance and aesthetics.

Meeting the needs of you, our customer is our top priority no matter how large or small your order whether it's standard product or specifically designed to meet your requirements our focus is to provide a quality product on time and as per agreed standards.

We are reliable partner for your lighting needs.

We also supply:

- Customised / Decorative Lighting Poles and brackets
- High masts for area illumination
- Sports lighting poles / Stadium Masts
- Monopoles / Poles for transmissions lines (Space saving alternative for Lattice Type Tower Structures)
- Monopoles for Telecom applications



For more than 65 years Valmont has offered steel pole and str

Typical drawing of High Mast

TECHNICAL SPECIFICATION OF HIGH MAST LIGHTING SYSTEM

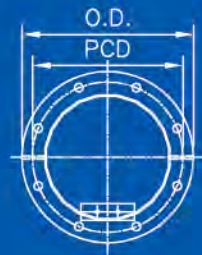
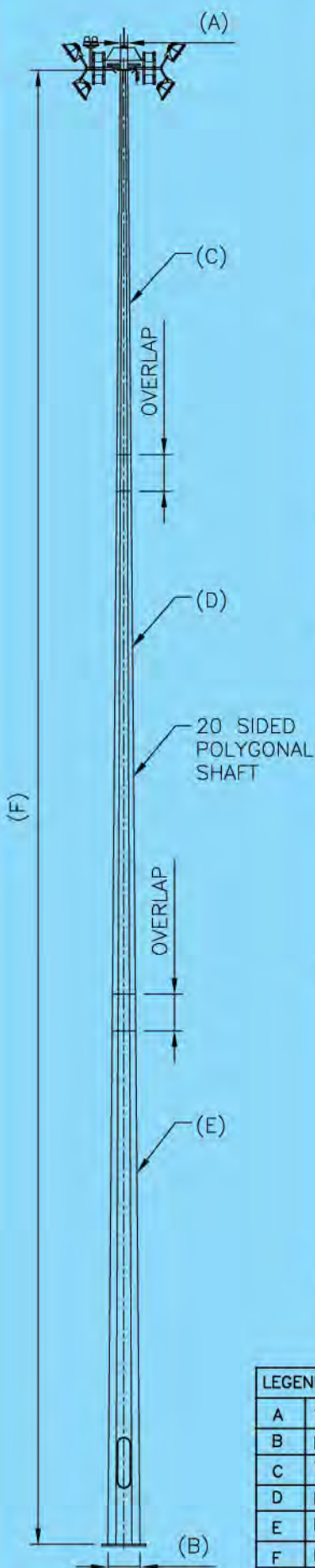

Baseplate Details

Anchor Bolt Cage Details

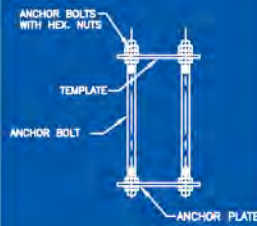

Mast Bottom



Head Frame Assembly

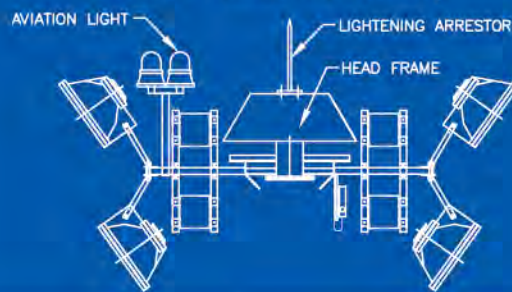

LEGENDS	
A	TOP A/F
B	BOTTOM A/F
C	TOP SECTION
D	MIDDLE SECTION
E	BOTTOM SECTION
F	MAST HEIGHT

Structure:

The Highmast is of continuously tapered, polygonal cross section, presenting a good and pleasing appearance and is based on proven design conforming to international standards, to give an assured performance, and reliable service. The structure is suitable for wind speed as per IS 875 part 3 1987.

Construction:

The mast is fabricated from special steel plates, conforming to ASTM A 572/ BS EN 10025 with 350MPa min. yield. Plates are cut, folded and welded using a sub-arc automatic machine to form a polygonal section. Silicon content of the steel shall be less than 0.06 % to provide a good galvanizing finish. No circumferential welded joints are provided in individual sections. The welding is in accordance with AWS. The mast is provided with fully penetrated flange, which is free from any lamination or incursion. For the environmental protection of the mast, the entire fabricated mast is single hot dip galvanized, internally and externally as per ASTM A 123 AND 153.

The mast is delivered in multiple sections of length up to 16 meters so a 30m mast can be delivered in two sections. At site the sections are joined together by slip-stressed-fit method. The minimum over lap distance is 1.5 times the outside diameter of the top section. The top/bottom diameters and plate thickness of the mast are designed as per CP3/IS 875 and TR No 7. The design life of the mast is a minimum of 25 years.

Door opening is provided at the base of the mast to access winches, cables and plug & socket, etc. The door opening is provided with a close fitting, vandal resistant and weatherproof door. It is provided with a heavy-duty double internal lock with special paddle key

Raising and lowering mechanism:

Raising and lowering mechanism is the most important part of the mast as it is to carry the load of the light fittings and help the operator to maintain the floodlights. As these lighting masts are installed in public areas, safety of this system is critical.

Lantern Installation ring:

A fabricated lantern installation ring is provided for fixing and holding the floodlight, fittings and control gear boxes. The lantern installation ring is made of steel tubes with provision for wiring cables. Electrical junction box is provided in the installation ring.

Winch:

Each mast is provided with single or double drum winch suitable for the following duties:

- Raising and lowering the luminaires
 - Supporting the luminaire in the raised position, unless a mechanical latching mechanism is provided
- These winches are type tested in the presence of a reputed institute (IIT, Bombay)

Electrical System, Cable and Cable Connections:

A suitable terminal box is provided at the base compartment of the high mast for terminating the incoming cable. Electrical connections from the bottom to the top are made of special rubber trailing cable with EPR insulation and PCP sheathing. A weather proof junction box to terminate the trailing cable is located at the top.

Power Tool:

The 3 phase 415V motor supplied to operate the winch shall be coupled with the winch using a sprocket & chain. Motor is mounted inside the base compartment of the mast. The lantern installation ring is controlled with a push button in order to provide maximum safety for the operator.

WHY VALMONT?

- Properly designed highmast with all structural, mechanical and electrical aspects.
- Valmont has carried out wind tunnel test at National wind tunnel facility, Kanpur.
- Valmont has carried out winch type test in the presence of IIT, Bombay.
- Valmont provides stainless steel wire rope manufactured by a reputed company.
- Valmont uses high tensile steel conforming to ASTM A 572/BSEN 100 25 with silicon less than 0.06%
- Valmont has India's biggest galvanizing facility in our own plant premises.
- Ultrasonic test for slip joint & liquid penetration test for surface crack.
- Valmont, the #1 supplier of highmasts in the World with over 95 factories located on all continents.



valmont 
INDIA

www.valmont.com
E-mail: sales.india@valmont.com

Mumbai Office: 909/910, FILIX, LBS Marg, Bhandup (W) Mumbai 400 078, India. Tel: +91 22 25952580

Pune Office: Unit 403, 4th floor, Pentagon 4, Magarpatta City, Hadapsar. Pune - 4110028. T: +91 20 30403830

Delhi Office: 1X-03, 1st Floor, ILD Trade Center, Sohna Road, Sec. 47, Gurgaon - 122001, India.

Factory: A-20, Indapur Industrial Area, MIDC, Indapur, Pune (Dist) Pin 413132, India.